

1. STĀVA PLĀNOJUMS

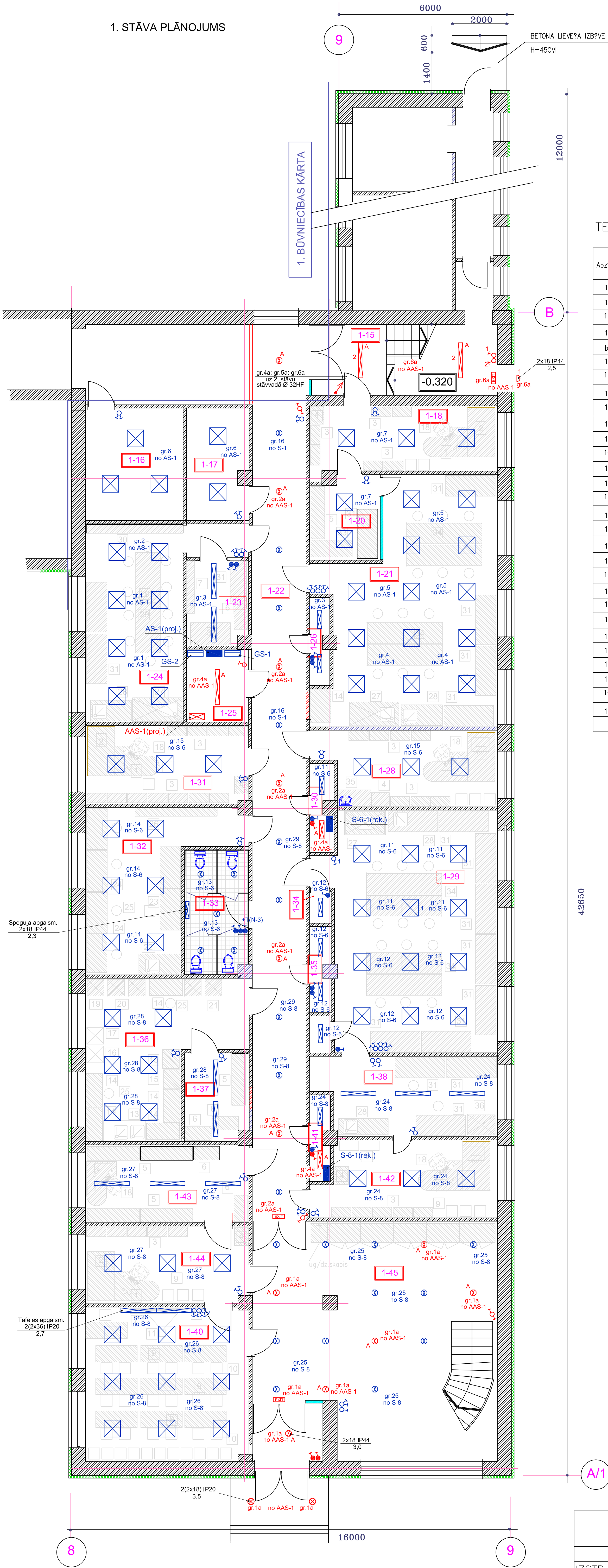

TELPU EKSPLIKĀCIJA

| Apzīmēj. | Nosaukums                 | Platība | E, lx | Gaismekļa tips, izpildījums                 | Daudz., gab | Mont. H, m | Spuldzes |          |              |
|----------|---------------------------|---------|-------|---|-------------|------------|----------|----------|--------------|
|          |                           |         |       |   |             |            | Tips     | Jauda, W | Daudz., gab. |
| 1-15     | KĀPĒTĀ TELPĀ              | 15.07   | 150   | TINA 2x36W IP44                             | 2           | 3,0        | T8       | 36       | 4            |
| 1-16     | PALĀTTELPA                | 14.52   | 200   | GCL 418, IP20                               | 3           | 3,0        | T8       | 18       | 12           |
| 1-17     | PALĀTTELPA                | 9.02    | 200   | GCL 418, IP20                               | 2           | 3,0        | T8       | 18       | 8            |
| 1-18     | KABINETS                  | 17.11   | 300   | GCL 418, IP20                               | 3           | 3,0        | T8       | 18       | 12           |
| b/n      | TEHN. TELPĀ               |         | 200   | TINA 2x18W IP44                             | 1           | 3,0        | T8       | 18       | 2            |
| 1-20     | PALĀTTELPA                | 7.38    | 200   | GCL 418, IP20                               | 2           | 3,0        | T8       | 18       | 8            |
| 1-21     | AUGU BIOLOĢ. LABORATORIJA | 48.81   | 500   | GCL 418, IP20                               | 13          | 3,0        | T8       | 18       | 52           |
| 1-22     | GAITENIS                  | 52.59   | 150   | D20 R210 218 IP20                           | 19          | 3,0        | TC-DEL   | 18       | 38           |
| 1-23     | NOLIKTAVA                 | 6.95    | 200   | TINA 2x36W IP44                             | 2           | 3,0        | T8       | 36       | 4            |
| 1-24     | MOLEK.BIOL. LABORATORIJA  | 25.74   | 500   | GCL 418, IP20                               | 8           | 3,0        | T8       | 18       | 32           |
| 1-25     | PALĀTTELPA                | 5.88    | 150   | TINA 2x36W IP44                             | 1           | 3,0        | T8       | 36       | 2            |
| 1-26     | TEHNISK. TELPĀ            | 2.77    | 200   | TINA 2x18W IP44                             | 2           | 3,0        | T8       | 18       | 4            |
| 1-28     | SAGATAVOTAVA              | 17.09   | 300   | GCL 418, IP20                               | 3           | 3,0        | T8       | 18       | 12           |
| 1-29     | AUGU FIZIOLOĢ. LABORATOR. | 49.87   | 500   | GCL 418, IP20                               | 12          | 3,0        | T8       | 18       | 48           |
| 1-30     | TEHNISK. TELPĀ            | 2.62    | 150   | TINA 2x18W IP44                             | 2           | 3,0        | T8       | 18       | 4            |
| 1-31     | KABINETS                  | 16.96   | 300   | GCL 418, IP20                               | 3           | 3,0        | T8       | 18       | 12           |
| 1-32     | LABORATORIJAS TELPĀ       | 24.25   | 500   | GCL 418, IP20                               | 6           | 3,0        | T8       | 18       | 24           |
| 1-33     | WC                        | 10.42   | 150   | D20 R210 218 IP44                           | 5           | 3,0        | TC-DEL   | 18       | 10           |
| 1-34     | PALĀTTELPA                | 1.03    | 100   | TINA 2x18W IP44                             | 1           | 3,0        | T8       | 18       | 2            |
| 1-35     | TEHNISK. TELPĀ            | 2.61    | 150   | TINA 2x18W IP44                             | 2           | 3,0        | T8       | 18       | 4            |
| 1-36     | ZINĀTNISK. LABORATORIJA   | 26.57   | 500   | GCL 418, IP20                               | 6           | 3,0        | T8       | 18       | 24           |
| 1-37     | AUKSTUMTELPA              | 6.41    | 200   | TINA 2x36W IP44                             | 2           | 3,0        | T8       | 36       | 4            |
| 1-38     | FITOKAMERA                | 19.24   | 200   | TINA 2x36W IP44                             | 3           | 3,0        | T8       | 36       | 6            |
| 1-40     | AUDITORIJA                | 33.82   | 500   | GCL 418, IP20                               | 9           | 3,0        | T8       | 18       | 36           |
| 1-41     | TEHNISK. TELPĀ            | 2.72    | 150   | TINA 2x18W IP44                             | 2           | 3,0        | T8       | 18       | 4            |
| 1-42     | KABINETS                  | 13.92   | 300   | GCL 418, IP20                               | 3           | 3,0        | T8       | 18       | 12           |
| 1-43     | NOLIKTAVA                 | 15.76   | 300   | TINA 2x36W IP44                             | 3           | 3,0        | T8       | 36       | 6            |
| 1-44     | KABINETS                  | 16.97   | 300   | GCL 418, IP20                               | 3           | 3,0        | T8       | 18       | 12           |
| 1-45     | KĀPĒTĀ HALLE AR VĒJTVERI  | 66.54   | 200   | D20 R210 218 IP20                           | 17          | 3,0        | TC-DEL   | 18       | 34           |
| ?        | RA NOUJUME                |         |       | D20 R210 218 IP44                           | 2           | 3,5        | TC-DEL   | 18       | 4            |
|          |                           |         |       | SPOĢUĀA APĢAISM. 2x18W IP44                 | 1           | 2,3        | T8       | 18       | 2            |
|          |                           |         |       | TĒPLES APĢAISMOJ. 2x36W IP20                | 2           | 2,7        | T8       | 36       | 4            |
|          |                           |         |       | sienas plafons 2x18W IP44                   | 1           | 2,5        | TC-DEL   | 18       | 2            |
|          |                           |         |       | ov?rijas i?ezas gaism. komplekt? ar spuldzi | 3           | -          |          |          | 3            |

APZĪMĒJUMI

- apgaismojuma sadalne;
- avārijas apgaism. sadalne;
- gaismeklis ar 4x18W luminiscentām spuldzēm;
- gaismeklis ar 2x18W luminiscentām spuldzēm;
- gaismeklis ar 2x18W lum. sp. ar iebūvētu akumulatoru;
- gaismeklis ar 2x36W luminiscentām spuldzēm, IP44;
- gaismeklis ar 2x36W lum. sp., IP44 ar iebūvētu akumulatoru;
- gaismeklis ar TC-DEL 2x18W luminiscentām spuldzēm;
- gaismeklis ar TC-DEL 2x18W lum. sp. ar iebūvētu akumulatoru;
- sienas plafons 2x18W IP44;
- gaismeklis "izeja" ar iebūvētu akumulatoru;
- stāvvads;
- slēdzis vienpolu, v/a;
- slēdzis vienpolu, v/a hermētisks;
- grupu slēdzis, v/a;
- slēdzis vadībai no divām vietām.

PIEZĪMES

1. Telpās 1-22 un 1-45 ir paredzēti piekārtos griestos iebūvējamie gaismekļi.

|   |                |  |  |                              |  |      |        |
|---|----------------|--|--|------------------------------|--|------|--------|
| LLU AAZL B?VNIEC?BA UN AAZI M?C?BU UN P?TNIEC?BAS<br>B?ZES REKONSTRUKCIJA STRAZDU IEL? 1, JELGAV? |                |  |  |                              | 13 – 001   |      |        |
|   |                |  |  |                              | EL   |      |        |
|   |                |  |  | M?C?BU UN P?TNIEC?BAS CENTRS | Stadija  | Lapa | M?rogs |
| IZSTR.  | M. KUDRJAVCEVA |  |  |                              | TP   | EL-2 | 1:100  |
|   |                |  |  | 1. ST?VA APGAISMOJUMA PL?NS  | <div></div> |      |        |
|   |                |  |  |                              |  |      |        |